

大牧人  
Big Herdsman



鸡用水线  
Water line for poultry

该乳头式饮水系统适用于各种禽类动物饮水，其结构简单可靠，供水及密封性能良好。

The nipple-type drinking water system features simple and reliable structure and good water supply and sealing and applies to water feeding of various kinds of poultry animals



青岛大牧人机械股份有限公司  
Big Herdsman Machinery CO.,LTD

让养殖变得简单/可靠/环保/高效  
Simple/Reliable/Green/Efficient



## 技术说明/Technical Description

- 水线前端采用二级过滤，有效过滤掉水中的杂质。
- 单独的反冲管路有利于准确记录鸡只的饮水情况。
- 专有的调压器可调节水压大小，从而调节乳头的出水量，适应不同日龄鸡只的饮水需求，并且带有反冲旋钮（手动/自动），方便冲洗水线。

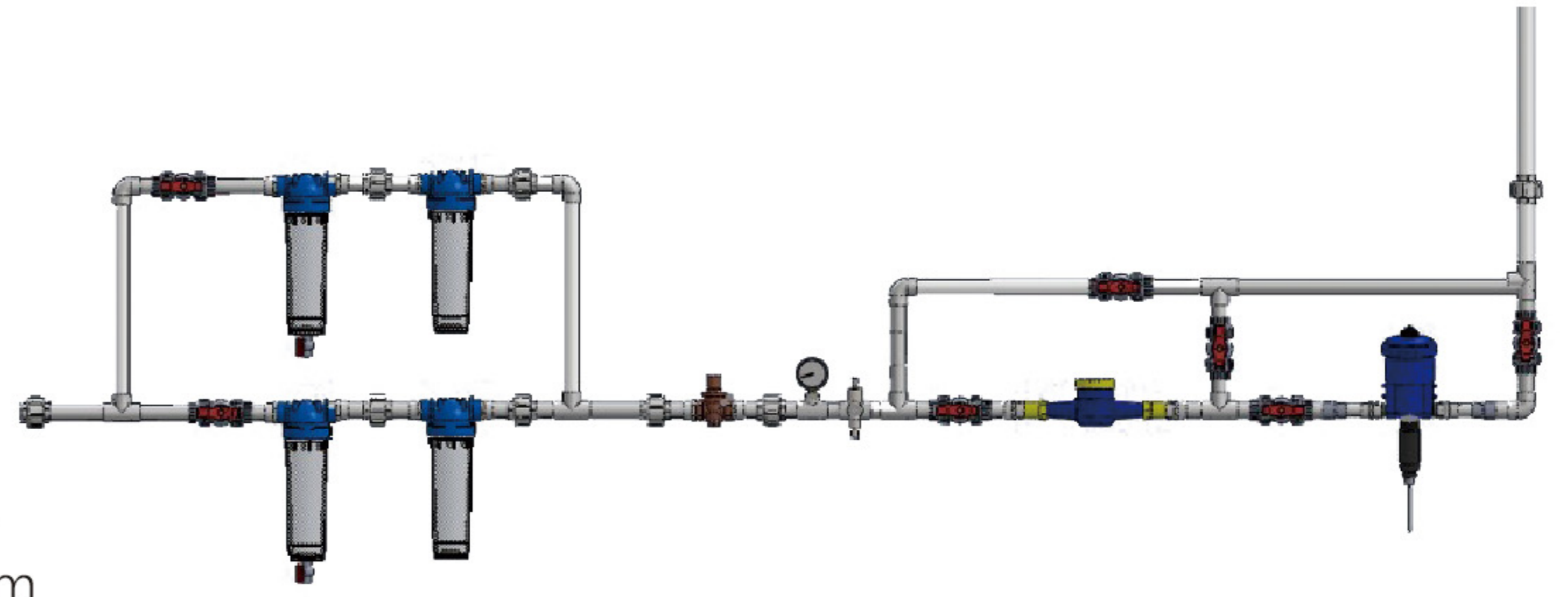

- 饮水乳头为双密封结构，360度侧击出水，上顶出水，保证鸡只在任何位置都可以喝到水。有红色、黄色两种饮水乳头：红色20cm水压乳头侧击平均出水量为18ml/min，种鸡常用；黄色20cm水压乳头侧击平均出水量为34ml/min，肉鸡常用。
- 饮水管配有可伸缩的公母接头，可消除因热胀冷缩产生的应力，避免损坏饮水管。
- 末端配有透明钢丝软管和集中排污管路，方便观察水位及冲洗水线。

- The water front parts is equipped with a double-layer filter, which can effectively filter impurities in water.
- The separate recoil line allows to accurately record how much water the chickens drink.
- The pressure regulator can be adjusted so as to adjust the nipple's water output, to meet the needs of the chicken's different age, and with a recoil knob (manual/automatic), easy to flush water line.
- The drinking nipples are double sealed structure, and they can flow by both 360 degrees side knocking and by top knocking, which ensure that chickens can drink water at any position. There are two kinds of drinking nipples, the red and the yellow, which are respectively used for breeding chicken and broiler feeding. The red nipples' average water flow is 18mL /min at 20cm water pressure, and the yellow nipples' average water flow is 34 mL /min at 20cm water pressure.
- The drinking pipes with retractable hermaphrodite connectors can relieve stress caused by thermal expansion and contraction, preventing damage to the pipe.
- The tube end is equipped with transparent steel wire hose and centralized drain line for easy observation of water level and flushing water line.

- 有红色、黄色两种饮水乳头，分别用于种鸡、肉鸡的喂养，360度侧击出水，上顶出水，出水量根据水压可调节，满足各日龄鸡只的饮水需求。

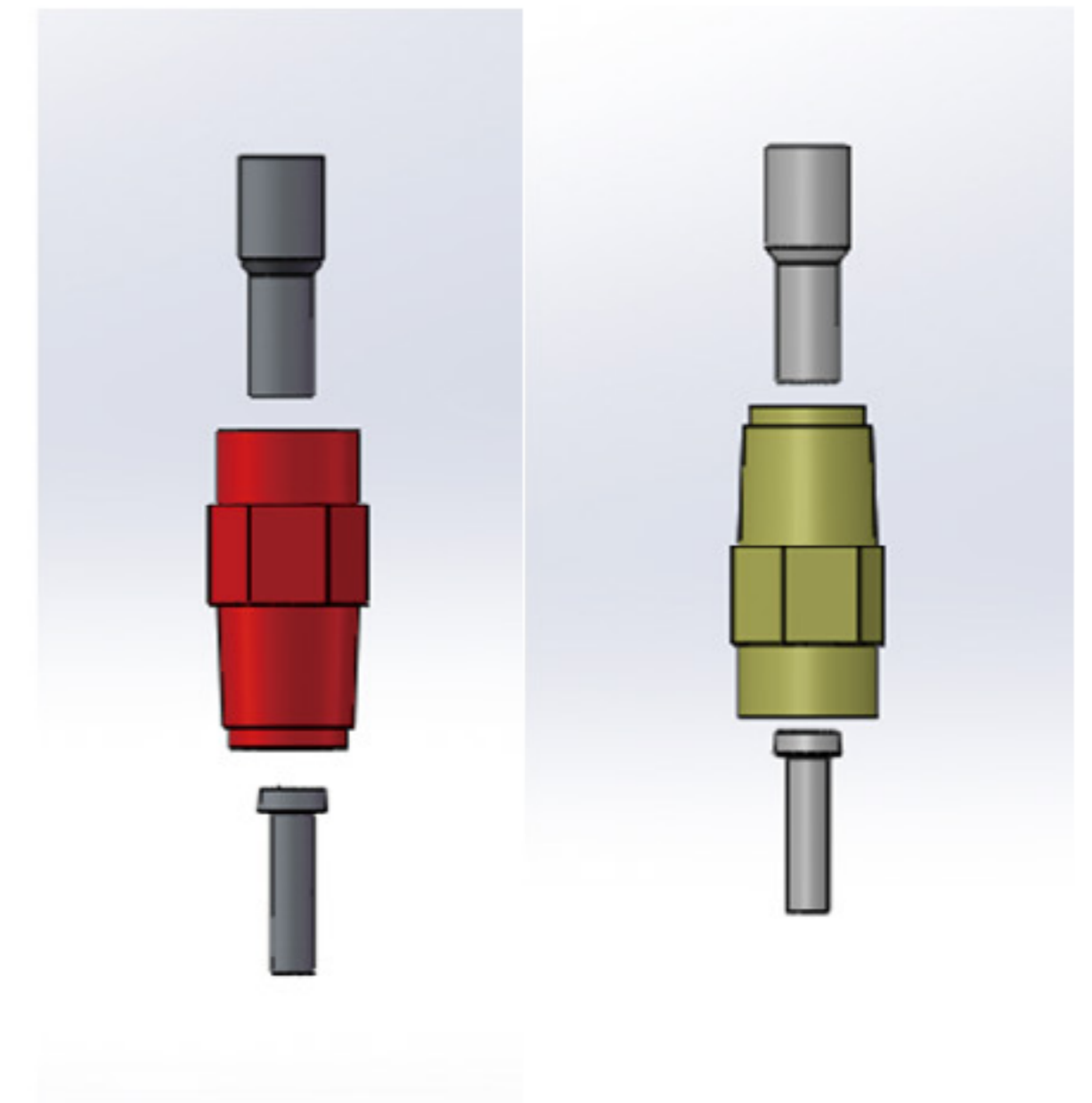

- There are two kinds of drinking nipples (red and yellow) for feeding breeders and broilers respectively. Water can come out from the upper top by laterally tapping in any direction within 360°. Its water flow can be adjusted according to water pressure to meet the drinking demands of the poultry of different ages in days.

## 技术参数 / Technical Parameters

序号 S/N	种类 Category	饲养量 Feeding capacity
1	肉鸡 Broiler	8-12 只/Unit 8-12birds/Unit
2	鸭 Duck	10 只/ Unit 10birds/Unit
3	种鸡 Breeder	10 只/ Unit 10birds/Unit

饮水乳头饲养量 Drinking nipple feeding capacity



### 青岛大牧人机械股份有限公司

地址: 青岛市城阳区空港工业园月河路  
电话: 0532-8493 3988  
网址: www.bigherdsman.com

#### QINGDAO BIG HERDSMAN MACHINERY CO.,LTD

Add: Yuehe road, Konggang industrial park, Qingdao city,  
Shandong Province, PR China  
Tel: +86-532-8493 3988  
Website: www.bigherdsman.com



微信扫描二维码，关注大牧人